

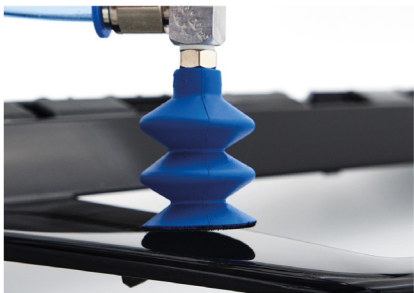

Series | Bellows vacuum cups SB

High-temperature Thermalon®-flocked bellows cups, 2.5 folds – SKT-B2

High-temperature Thermalon®-flocked bellows cups, 2.5 folds – SKT-B2



Product notes	Advantage
<p>Bellows vacuum cup made of proven Thermalon® with additional patented flock coating of the contact surfaces for the highest demands on non-marking gripping.</p> <p>Ideally suited for uneven surfaces with special suitability for the removal of hot plastic parts to be painted from the injection molding machine.</p> <p>Thermalon® is a material mixture with a hardness of 60° Shore A, specially optimized for the plastics industry.</p> <p>Flock coating made of thin polyamide layer PA6.6 black.</p> <p>Connection by means of plug nipple.</p>	<ul style="list-style-type: none">> Nearly non-marking> Quick depositing of the product, as there is no static friction due to thin flock coating> Free of silicone and other paint-wetting-impairment substances (PWIS)> Large suction stroke and good adaptation to curved or uneven product surfaces> • Temperature-resistant up to 160 °C (320 °F)

Notes:

The flock coating could cause leakage, which must be taken into account in the layout of the vacuum source.

Technical data

Item no.	Model		Number of folds	Material / Color	Required suction power for 60 % vacuum [Nl/min]	Short-term working temperature < 30 Sec [°C (°F)]
21.009.148.19F	SKT-B2-9	3	2.5	Thermalon®-flocked (bl/sw)	10	0 - 160 (32 - 320)
21.012.149.19F	SKT-B2-12	7	2.5	Thermalon®-flocked (bl/sw)	11	0 - 160 (32 - 320)
21.014.150.19F	SKT-B2-14	10	2.5	Thermalon®-flocked (bl/sw)	16	0 - 160 (32 - 320)
21.020.152.19F	SKT-B2-20	10	2.5	Thermalon®-flocked (bl/sw)	17	0 - 160 (32 - 320)
21.025.153.19F	SKT-B2-25	20	2.5	Thermalon®-flocked (bl/sw)	18	0 - 160 (32 - 320)
21.032.154.19F	SKT-B2-32	14.5	2.5	Thermalon®-flocked (bl/sw)	18	0 - 160 (32 - 320)
21.042.155.19F	SKT-B2-42	22	2.5	Thermalon®-flocked (bl/sw)	21	0 - 160 (32 - 320)

Accessories

Item no.	 Suitable fittings						
	M5-male	M5-female	M6-male	G1/8-male	G1/8-female	G1/4-male	G1/4-female
21.009.148.19F	270.772	270.347	270.104	270.033	270.478	--	--
21.012.149.19F	270.772	270.347	270.104	270.033	270.478	--	--
21.014.150.19F	270.772	270.347	270.104	270.033	270.478	--	--
21.020.152.19F	270.772	270.347	270.104	270.033	270.478	--	--
21.025.153.19F	270.772	270.347	270.104	270.033	270.478	--	--
21.032.154.19F	--	--	270.315	270.196	270.114	270.190	270.192
21.042.155.19F	--	--	270.315	270.196	270.114	270.190	270.192

Dimensions

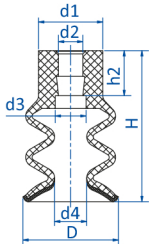

Drawing A

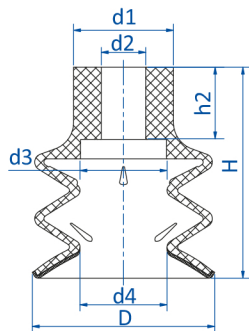

Drawing B

Item no.	Drawing	Ø D [mm]	Ø d1 [mm]	Ø d2 [mm]	Ø d3 [mm]	Ø d4 [mm]	H [mm]	h2 [mm]
21.009.148.19F	A	10.1	9	3.8	--	3.9	15.5	7
21.012.149.19F	A	12.9	10	3.8	4.8	5	21.5	7
21.014.150.19F	A	14.9	10	3.8	4.8	5	23.5	7
21.020.152.19F	A	20.9	10	3.8	4.8	10	23.5	7
21.025.153.19F	A	25.9	10	3.8	4.8	10.1	34.5	7
21.032.154.19F	B	32.9	18	8	15.7	15.7	38	13
21.042.155.19F	B	42.9	18	8	15	18	46.5	13